

# INSTRUCTIONS FOR RESETTING COMBINATION

## 1 SET DIALS TO UNLOCK POSITION

Set the dials in the order that will make the door knob turn. Either its the current combination code or the factory set code 0000 if this is the first time using the door knob.

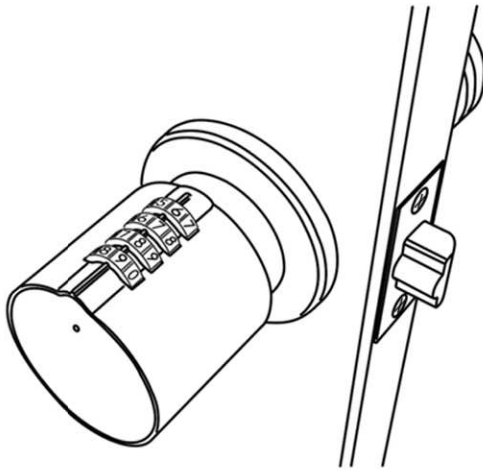

## 2 USE PIN TO RESET THE COMBINATION

Use a push pin or a similar device and slide it into the hole on the face of the door knob. Apply pressure to engage the reset mechanism.

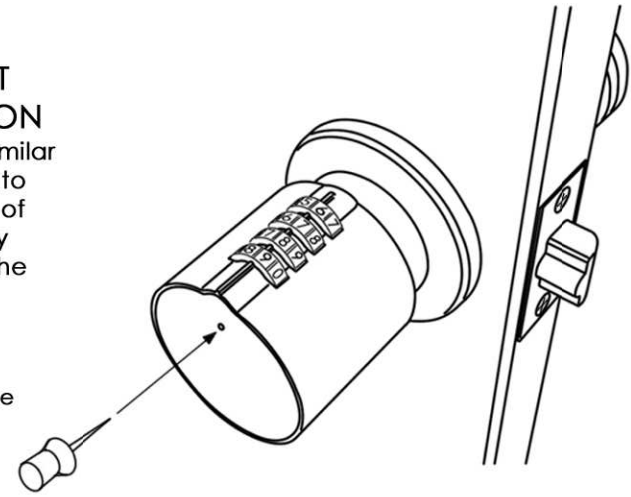

NOTE: Push pin works the best. Tention from the combination dials is normal.

## 3 CHANGE COMBINATION CODE

While applying pressure with the pin, change the combination code to your desired number combination.

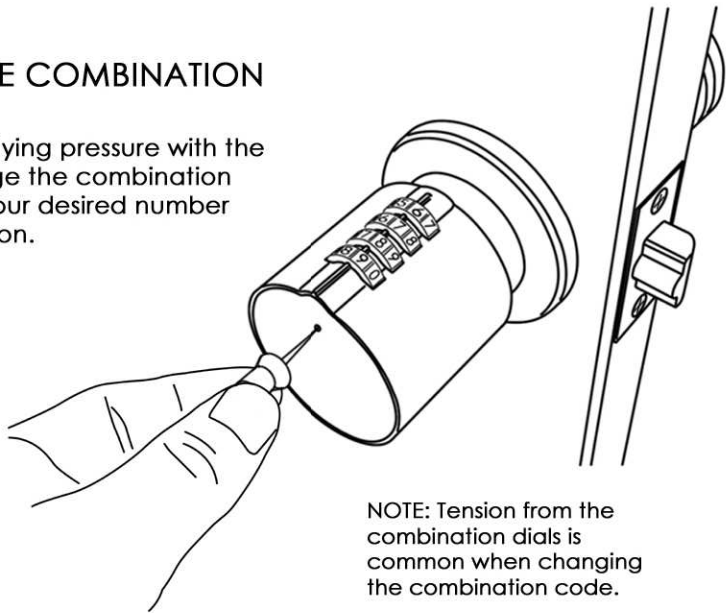

NOTE: Tension from the combination dials is common when changing the combination code.

### NOTE!!

1. When changing combination, it is easier to perform when door knob is installed.
2. Installation Screws must be tightened fully.
3. Please call or E-mail us with any issues or questions.

**1 YEAR LIMITED WARRANTY**  
If at anytime this product stops functioning, please send it back for a full replacement. Limited to physical damage and the condition of the product.

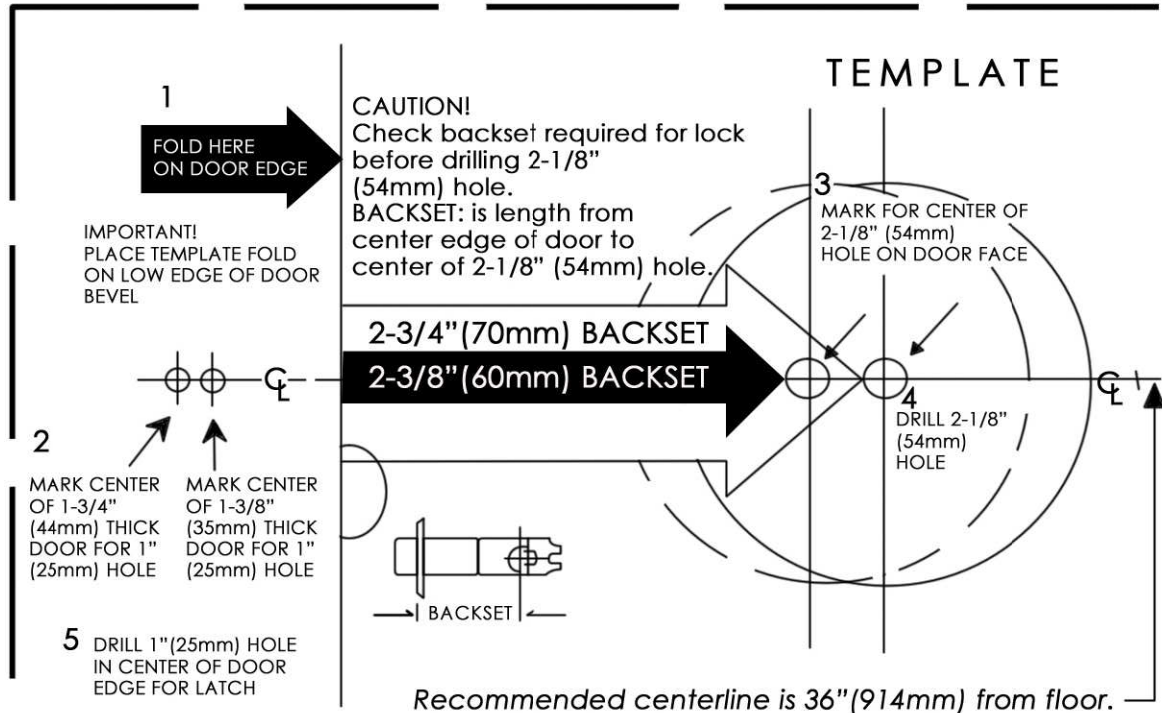

www.GSALocks.com  
email: info@GSALocks.com



# INSTRUCTIONS FOR INSTALLING LOCKSET

## 1 MARK DOOR

Place template on outside of door with height center line 36" from floor. Mark both holes as shown.

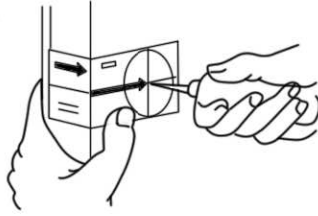

## 2 DRILL TWO HOLES

Drill a 2-1/8" through face of door. Drill 1" hole straight into edge of door, mortise for latch face until flush and install latch bolt.

Drill the 2-1/8" hole from both sides of the door.

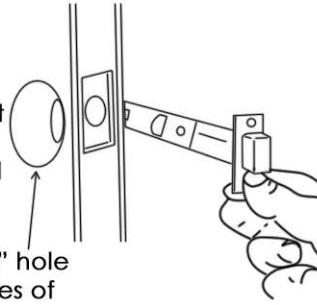

## 3 INSTALL STRIKE ON DOOR JAMB

Transfer the vertical center line and the height line to the jamb. Drill 1-1/16" hole 7/8 deep. Cut out jamb until flush and install strike, setting the screw holes on the center line. (Adjustable permits bending in or out to eliminate excessive looseness between door and stop).



## 4 INSTALL OUTSIDE KNOB

Insert outside knob with spindle into latch, making certain that stems are positioned correctly through latch holes. Press flush against door. For easier insertion of spindle, depress latchbolt.

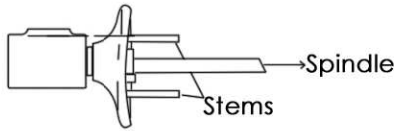
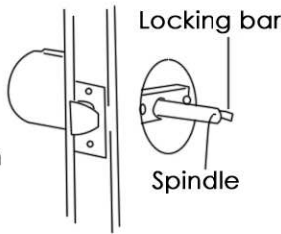

## 5 INSTALL INSIDE ASSEMBLY

Slip inside assembly over spindle and locking bar (Turn button must be in horizontal position to receive locking bar.) Insert screws through mounting plate and tighten evenly until snugly secured.

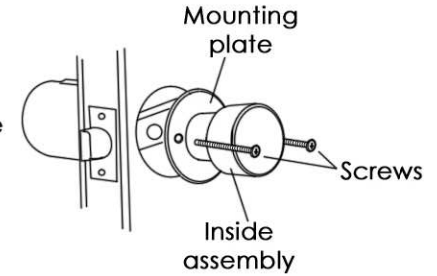

## KNOB ALIGNMENT

When installing the outer knob which is the one with the combination dials, you must make sure the spinning spindle rod is facing up. To make sure it is facing up, spin the spindle so the larger gap is facing up in alignment with the combination dials. You can see the two gaps on the inside face of the outer door knob mounting plate.

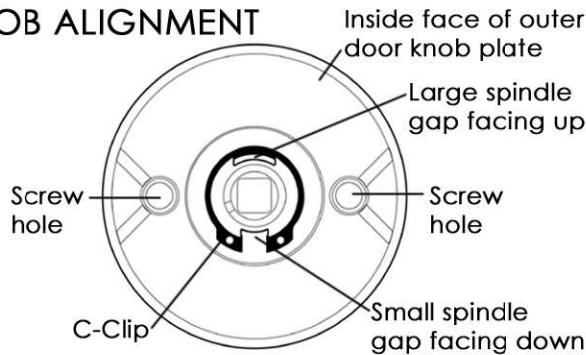

## SPRING PLACEMENT

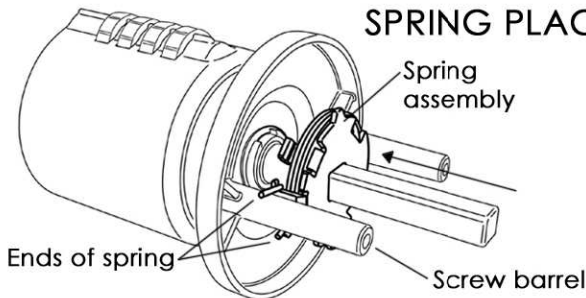

Spring assembly must slide into the outer knob assembly in this particular way where the ends of the spring slide over on one of the screw barrels.

## HOW TO USE THE ADJUSTABLE LATCH

1. The latch is factory preset at 2 1/4" (57mm) backset, which is standard for most doors.
2. To use the 2 1/4 backset no adjustment is required. Simply insert the screw stems on the outside knobs thru holes (A) and (C) of the latch, proceed to step 4 of the instructions for installing lockset.

### FOR 2 5/8(68 MM) BACKSET INSTALLATION

1. Push in front of latch (e) and hold it.
2. Use a screwdriver to push the black insert slide extension up or down from inside the latch. For best results, while keeping the latch depressed, push down on the top front (closest to E) of the extension slide, while at the same time releasing the latch.
3. Latch is ready for installation.
4. When using the 2 5/8" backset, lockset screw stems are inserted through hole (B) of the latch and against the outside of location (D) on the latch. Proceed to step 4 of the instructions for installing the lockset

