

Lock Cover Specifications



KEY FEATURES

General Information

- Protects a wide range of equipment against abuse, accidental damage and theft.
- can be used over volume and lighting controls.
- Three year guarantee against breakage of polycarbonate in normal use.

Design

- Constructed of tough polycarbonate material, the covers can protect a wide range of devices.

Construction

- Covers are molded from thick, super tough polycarbonate material.
- All covers and hinges are molded from thick polycarbonate material that is UV-stabilized.
- 94V-2 flammability rating.

Installation

- Fast, easy installation.
- Comes complete with mounting hardware and gasket.
- Typical working properties of polycarbonate are -40° to 250°F (-40° to 121°C).

Options

- Covers come in clear or in smoke color where privacy is required

PRODUCT OVERVIEW

These tough covers protect devices from abuse, accidental damage and theft of access/keypad codes. Available in clear or smoke, for applications requiring privacy. The covers can protect a wide range of devices. All covers and hinges are molded from thick polycarbonate material that is UV-stabilized.

HOW IT WORKS

Comes with a 3-year guarantee against breakage of polycarbonate covers in normal use. They are easy to install and are shipped complete with anchors, screws and gasket. Gasket replacement is recommended every five years.

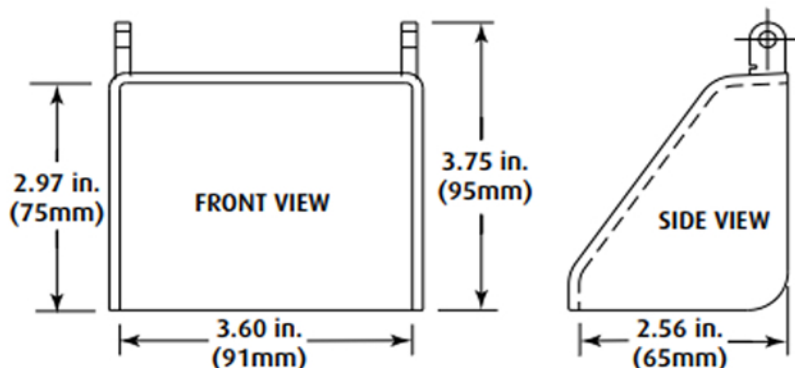

Lock Cover Installation

INSTALLATION:

1. Cut out template and place it around unit as shown.
2. Remove backing paper from gasket and center gasket around template with surface "A" lying on surface "B" of template.
3. Using spacer as drill template mark and drill three (3) 3/16 in. diameter holes. Complete installation as shown.

OPTIONAL: If anchors are not required, use spacer as template, mark and drill (3) holes using a #32 drill bit.

CLEANING INSTRUCTIONS

Rinse with water to remove abrasive dust and dirt. Wash with soap or mild detergent using a soft cloth. DO NOT SCRUB OR USE BRUSHES OR ABRASIVES. Rinse once more, then dry with a soft cloth or chamois. To remove grease or wet paint, rub gently with a damp cloth thoroughly with naphtha. Then wash and rinse. DO NOT USE RAZOR BLADES.

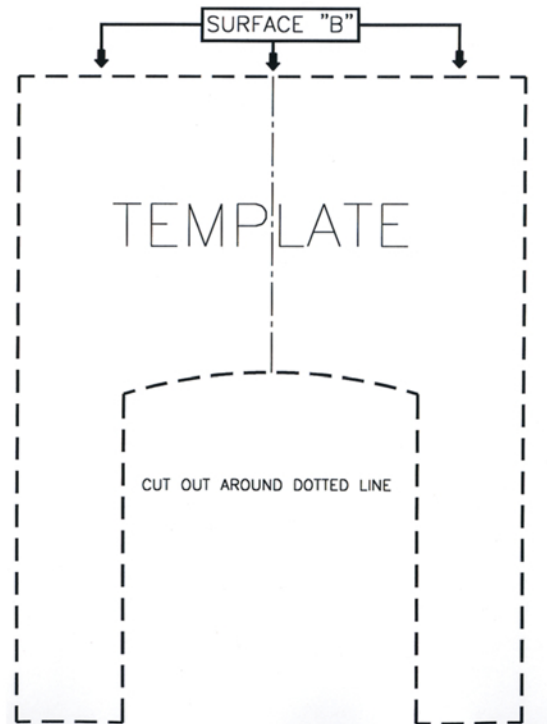
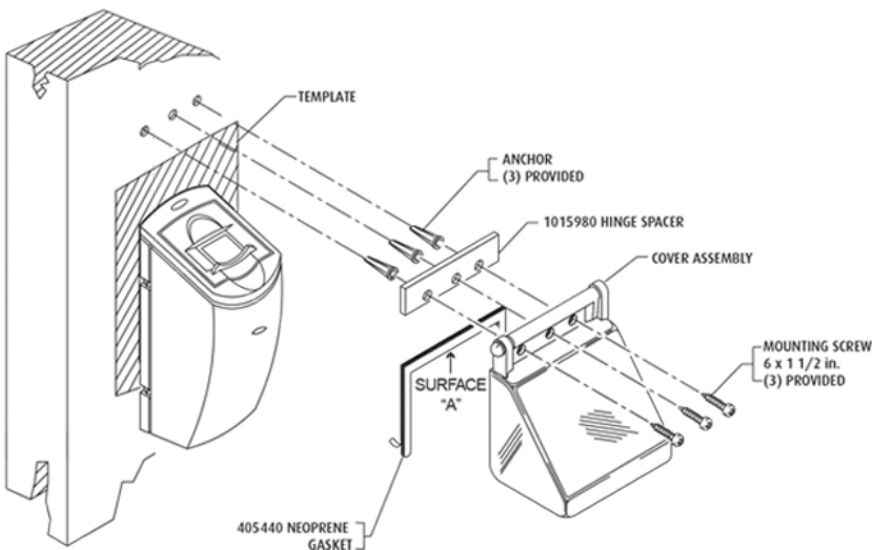
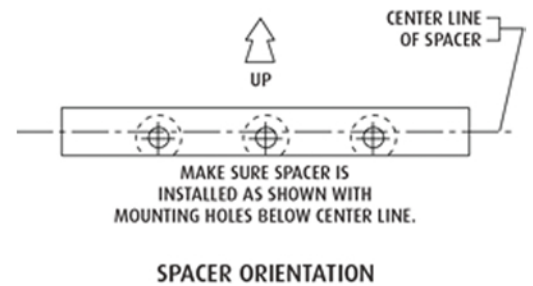
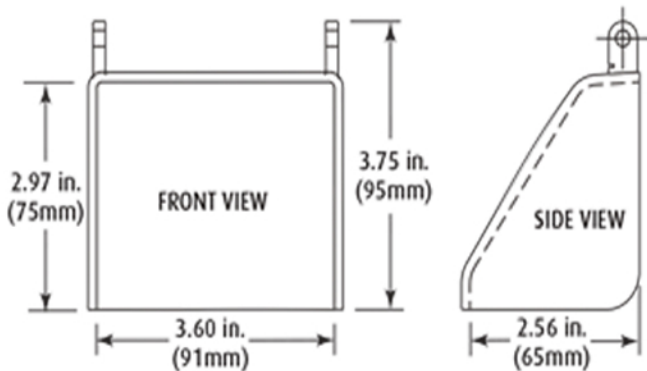

All specifications and information shown were current as of publication, and are subject to change without notice.

